

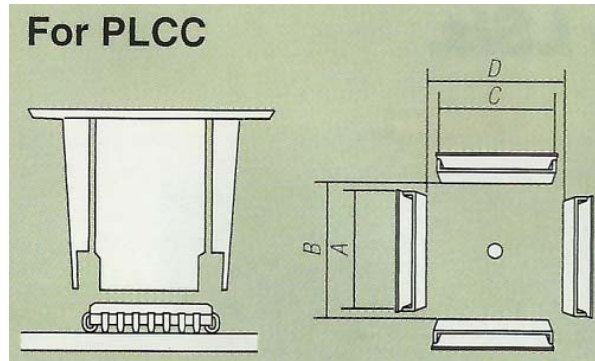

OPTIONAL NOZZLES



Specifications:

P/N	Nozzle number	A		B		C		D		Applicable Package
		inch	mm	inch	mm	inch	mm	inch	mm	
XNP 7.3 X 12.5	300	0.272	6.9	0.354	9	0.272	6.9	0.551	14	PLCC 7.3 X 12.5
XNP 11.5X11.5	301	0.394	10	0.512	13	0.394	10	0.512	13	PLCC 28
XNP 11.5 X 14	302	0.591	15	0.591	15	0.394	10	0.512	13	PLCC 11.5 X 14
XNP 17.5 X 17.5	303	0.591	15	0.728	18.5	0.591	15	0.728	18.5	PLCC 44
XNP 20 X 20	304	0.748	19	0.827	21	0.748	19	0.827	21	PLCC 52
XNP 25 X 25	305	0.945	24	1.024	26	0.945	24	1.024	26	PLCC 68
XNP 30 X 30	306	1.142	29	1.220	31	1.142	29	1.220	31	PLCC 84

These nozzles are suitable for these GOOT XFC Hot air Stations:

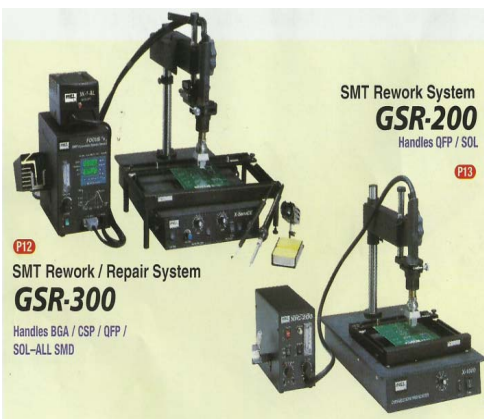
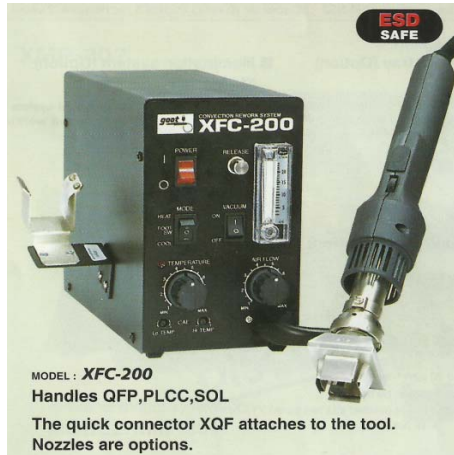
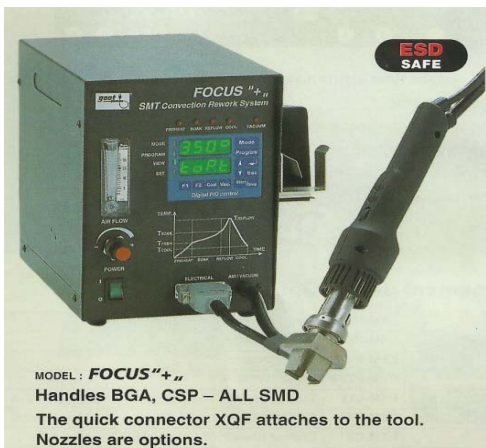

SURFACE-MOUNT / SMT PRODUCTS

XFC Series Optional Nozzles (PAT.)

XNSG series (for SO, SOL)

P / N	A		D		Applicable Package
	inch	mm	inch	mm	
XNSG 4.4 × 10	0.394	10	0.189	4.8	SO16
XNSG 5.6 × 13	0.591	15	0.224	5.7	SSOP8T
XNSG 7.6 × 15	0.630	16	0.283	8.2	SOL20/26, TSOP20/24
XNSG 7.6 × 18	0.748	19	0.283	8.2	TSOP24
XNSG 7.6 × 12.7	0.472	12	0.283	8.2	SOL20, TSOP28
XNSG 19 × 8	0.315	8	0.748	19.0	TSOP32
XNSG 8.6 × 18	0.748	19	0.343	8.7	TSOP28/32
XNSG 18.5 × 12	0.591	15	0.728	19.5	TSOP40/48
XNSG 13 × 28	1.142	29	0.531	13.5	PSOP44
XNSG 4.4 × 5	0.197	5	0.189	4.8	S08

XNSG series (for SOJ)

P / N	A		D		Applicable Package
	inch	mm	inch	mm	
XNSG 15 × 8.2	0.591	15	0.323	8.2	SOJ20

XNPG series (for PLCC)

P / N	A		B		C		D		Applicable Package
	inch	mm	inch	mm	inch	mm	inch	mm	
XNPG 7.3×12.5	0.272	6.9	0.354	9	0.272	6.9	0.551	14	PLCC 7.3 X 12.5
XNPG 11.5×11.5	0.394	10	0.512	13	0.394	10	0.512	13	PLCC 28
XNPG 11.5×14	0.591	15	0.591	15	0.394	10	0.512	13	PLCC 11.5 X 14
XNPG 17.5×17.5	0.591	15	0.728	18.5	0.591	15	0.728	18.5	PLCC 44
XNPG 20 × 20	0.748	19	0.827	21	0.748	19	0.827	21	PLCC 52
XNPG 25 × 25	0.945	24	1.024	26	0.945	24	1.024	26	PLCC 68
XNPG 30 × 30	1.142	29	1.220	31	1.142	29	1.220	31	PLCC 84

Custom nozzles are available. Please contact a **goot** distributor.

XNQG series (for QFP, BQFP)

P / N	A		B		C		D		Applicable Package
	inch	mm	inch	mm	inch	mm	inch	mm	
XNQG 12 × 12	0.472	12	0.551	14	0.472	12	0.551	14	QFP64,QFP48,QFP80,BQFP28
XNQG 14 × 14	0.591	15	0.677	17.2	0.591	15	0.677	17.2	SQFP100, TQFP100
XNQG 14 × 20	0.591	15	0.665	16.9	0.827	21	0.906	23	SQFP12, QFP80, QFP100
XNQG 16 × 16	0.630	16	0.826	21	0.629	16	0.826	21	BQFP100T25, QFP163
XNQG 17.5×17.5	0.591	15	0.728	18.5	0.591	15	0.728	18.5	BQFP84
XNQG 24 × 24	0.827	21	0.953	24.2	0.827	21	0.953	24.2	BQFP132, FQFP176
XNQG 28 × 28	1.142	29	1.220	31	1.142	29	1.220	31	QFP128, SQFP208
XNQG 32 × 32	1.220	31	1.315	33.4	1.220	31	1.315	33.4	BFP184T, FQFP408
XNQG 37 × 37	1.220	31	1.457	37	1.220	31	1.457	37	BQFP196
XNQG 40 × 40	1.535	39	1.654	42	1.535	39	1.654	42	BQFP244

XNBG series (for BGA)

P / N	A		Applicable Package
	inch	mm	
XNBG 8 × 8	0.393	10	BGA16, BGA25
XNBG 12 × 12	0.551	14	BGA49, BGA64
XNBG 13 × 13	0.590	15	BGA49, BGA64
XNBG 15 × 15	0.669	17	BGA81, BGA100
XNBG 17 × 17	0.748	19	BGA121
XNBG 19 × 19	0.787	20	BGA144, BGA121
XNBG 23 × 23	0.984	25	BGA169
XNBG 27 × 27	1.142	29	BGA324, BGA225, BGA289
XNBG 35 × 35	1.457	37	BGA529, BGA484
XNBG 38 × 38	1.575	40	BGA576, BGA625
XNBG 40 × 40	1.654	42	BGA625, BGA676

XNSG series SO, SOL

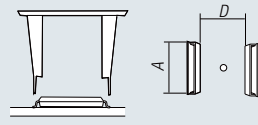

XNSG series SOJ

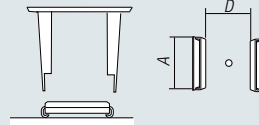

XNQG series QFP / BQFP

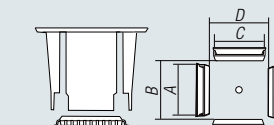

For Discrete Components

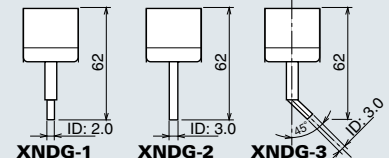

XNPG series PLCC

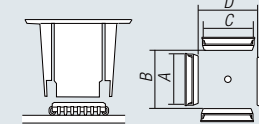

XNBG series BGA

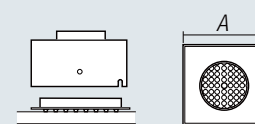

XNDG-1

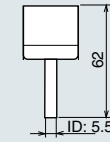

XNDG-2

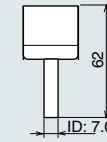

XNDG-3

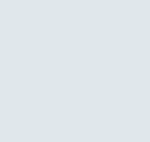

XNDG-4



XNDG-5

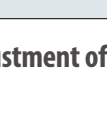

Fixes the XFC series handpiece securely.

HANDPIECE HOLDER XK-1

RoHS



- Holder for XFC handpiece to attach to XPR-600/1000 preheater.

MODEL	XK-1
Dimensions	Holder : 330(L) x 110(W) x 160(H)mm Column : ø28 x 390 mm
Weight	Holder :1.5 kg / Column:480 g

Secure fixing and micro-adjustment of the XFC series handpiece.

HANDPIECE HOLDER XK-2

RoHS

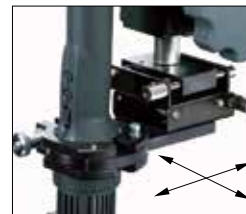

- Allows micro-adjustment of the XFC series handpiece while holding an SMD. Makes mounting work easy.

MODEL	XK-2
X direction adjustable range	20 mm
Y direction adjustable range	20 mm
Control knob pitch	0.8 mm per one complete turn
Dimensions	Holder : 330 (L) x 110 (W) x 196 (H) mm Column : ø28 x 390 mm
Weight	Holder : 1.8 kg / Column : 480 g