

BATTERY LEAD ACID 12V 36A HW

Model: CP36-12

PHYSICAL SPECIFICATION

Nominal Voltage		12V
Nominal Capacity (10HR)		36Ah
Dimension	Length	196±2mm (7.72 inches)
	Width	131±2mm (5.16 inches)
	Container Height	163±2mm (6.42 inches)
	Total Height	179±2mm (7.05 inches)
Weight		Approx. 10.5Kg (23.14lbs)
Standard Terminal		Bolt-and-nut lead terminal Bolt Type: M6



B3(Bolt-and-nut lead terminal)
Bolt Type:M6

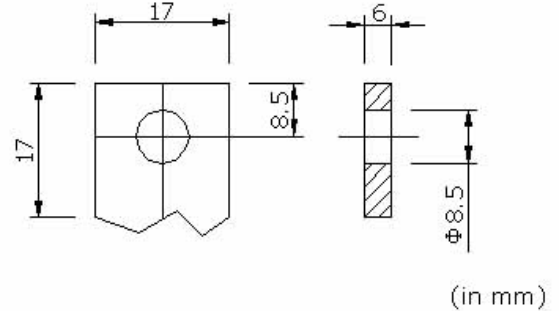
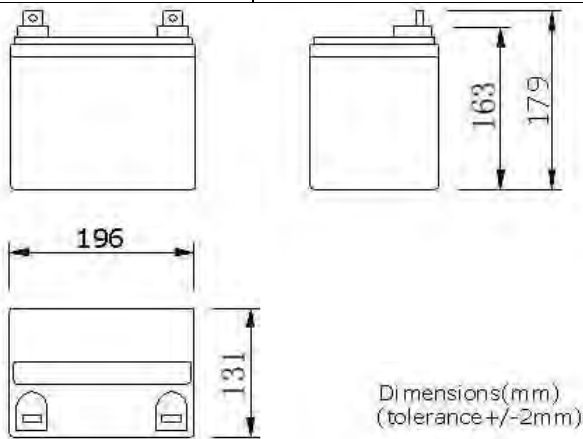

ELECTRICAL SPECIFICATION

Characteristics

Capacity	10 hour rate (3.6A)	36Ah
	5 hour rate (6.1A)	31Ah
	3 hour rate (9A)	27Ah
	1 hour rate (21.6A)	21.6Ah
Capacity affected by temperature	40°C (104 °F)	102%
	25°C (77 °F)	100%
	0°C (32 °F)	85%
Internal Resistance		Full charged battery (25°C, 77 °F) 10mΩ
Constant Voltage Charge	Cycle	Initial Charging Current less than 9A Voltage 14.1~14.4V at 25°C (77 °F) Temperature Coefficient -30mV/°C
	Standby	No limit on Initial Charging Current Voltage 13.5~13.8V at 25°C (77 °F) Temperature Coefficient -20mV/°C

Discharge curves @ 25°C (77 ° F)

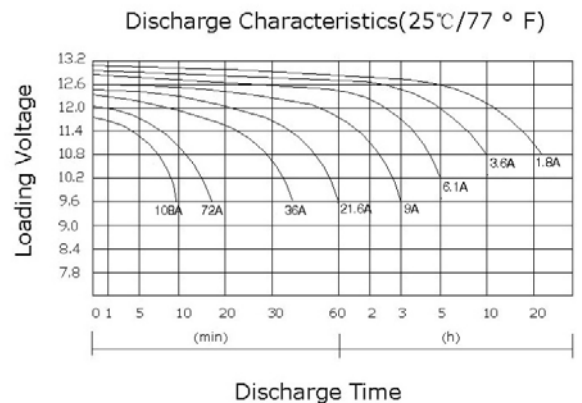

Made in China